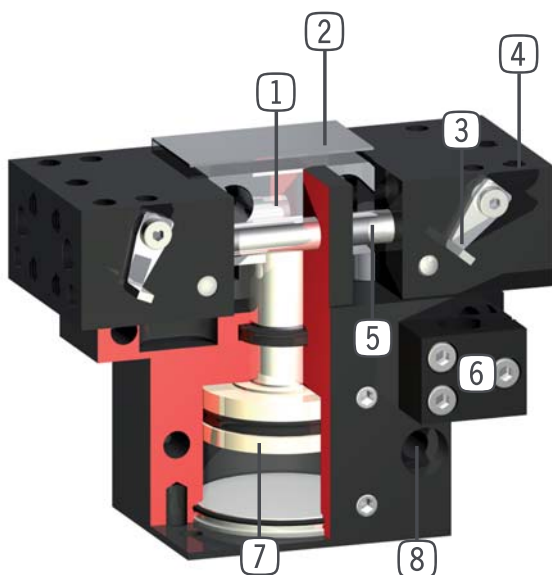

**Versions:**

e.g. order no.: GP45 ☐ -B ☐

- S** ▶ For external gripping, gripping force safety under drop in pressure from integral spring,  
**-99** ▶ Without integrated spring

GP100S also has a steeper crank for greater gripping force and reduced stroke

**Product information:**

- ▶ Economical due to high reliability and long lifetime
- ▶ Proven design in many cases
- ▶ Switch cam installed on gripper jaw for position sensing
- ▶ Double acting pneumatic cylinder with integrated mechanical gripping force safety device (s-Model)
- ▶ Maintenance free up to 10 million cycles
- ▶ High temperature resistant version (up to 150°C) available upon request

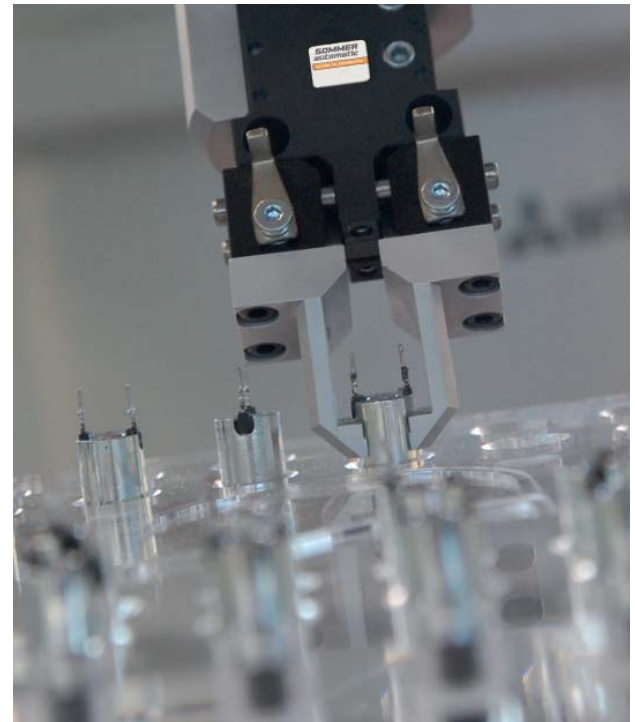
**Application example:****Design:**

- 1 Positively driven wedge hook mechanism**
  - synchronized gripper jaw movement
  - high force transfer
- 2 Cover plate**
  - To protect the guide and mechanics (from GP45)
- 3 Adjustable switch cam**
  - for position sensing
- 4 Gripper jaw**
  - individual gripping jaw intake
- 5 Roller slide**
  - for individual gripper finger mounting
- 6 Mounting block**
  - mounting for inductive proximity switch
- 7 Drive**
  - double acting pneumatic cylinder
- 8 Mounting and positioning**
  - mounting possible from several sides for versatile positioning

► Installation size: **GP12**

Dimension			Forces and moments			
B [mm]	H [mm]	T [mm]	Mr [Nm]	Mx [Nm]	My [Nm]	Fa [N]
25	33	15	0.15	0.15	0.15	15

Technical Data				
Order no.	Stroke per Jaw [mm]	Weight [kg]	Gripping force [N]	
			closing	opening
GP12-B	3	0.033	8.4	4

## Gripping force diagram

► Installation size: **GP19**

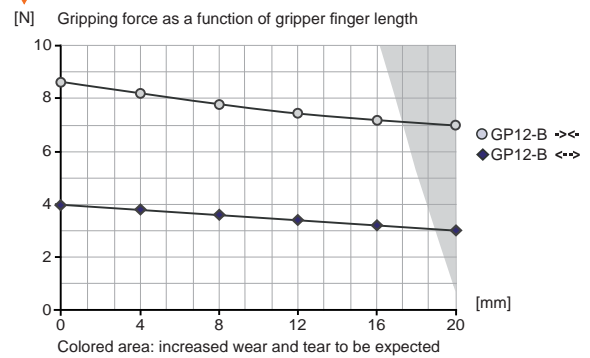
Dimension			Forces and moments			
B [mm]	H [mm]	T [mm]	Mr [Nm]	Mx [Nm]	My [Nm]	Fa [N]
34	45	20	0.8	0.8	0.8	40

Technical Data*				
Order no.	Stroke per Jaw [mm]	Weight [kg]	Gripping force [N]	
			closing	opening
GP19-B	4	0.081	36	26

## Gripping force diagram

► Installation size: **GP30**

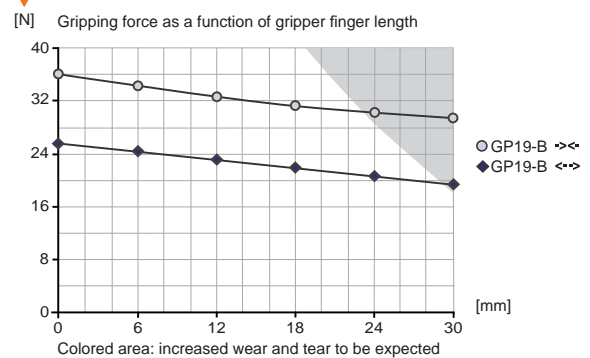
Dimension			Forces and moments			
B [mm]	H [mm]	T [mm]	Mr [Nm]	Mx [Nm]	My [Nm]	Fa [N]
40	50	28	2	2	2	80

Technical Data*				
Order no.	Stroke per Jaw [mm]	Weight [kg]	Gripping force [N]	
			closing	opening
GP30-B	5	0.152	94	76

## Gripping force diagram

► Installation size: **GP45**

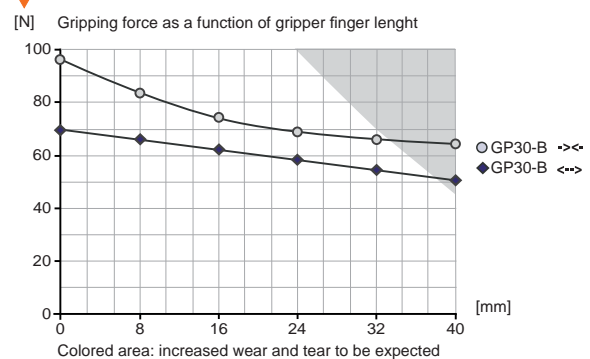
Dimension			Forces and moments			
B [mm]	H [mm]	T [mm]	Mr [Nm]	Mx [Nm]	My [Nm]	Fa [N]
39.6	50	39.6	4	4	4	160

Technical Data*				
Order no.	Stroke per Jaw [mm]	Weight [kg]	Gripping force [N]	
			closing	opening
GP45-B	5	0.255	118	155
GP45S-B	5	0.3	190	-

## Gripping force diagram

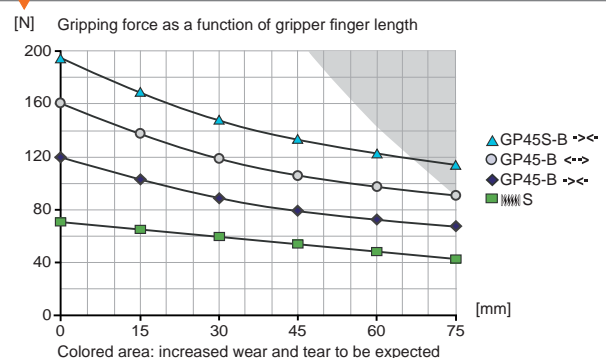

► Installation size: **GP75**

Dimension			Forces and moments			
B [mm]	H [mm]	T [mm]	Mr [Nm]	Mx [Nm]	My [Nm]	Fa [N]
70	67.5	39.6	5	5	5	180

Technical Data*				
Order no.	Stroke per Jaw [mm]	Weight [kg]	Gripping force [N]	
			closing	opening
GP75-B	10	0.45	220	260
GP75S-B	10	0.5	275	-

► Installation size: **GP100**

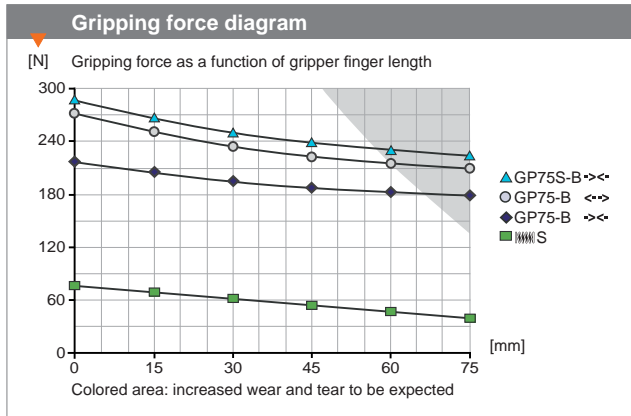
Dimension			Forces and moments			
B [mm]	H [mm]	T [mm]	Mr [Nm]	Mx [Nm]	My [Nm]	Fa [N]
120	87	49.4	10	10	10	400

Technical Data*				
Order no.	Stroke per Jaw [mm]	Weight [kg]	Gripping force [N]	
			closing	opening
GP100-B	13	1.4	450	-
GP100-B-99	13	1.4	450	450
GP100S-B	8	1.4	5250	-



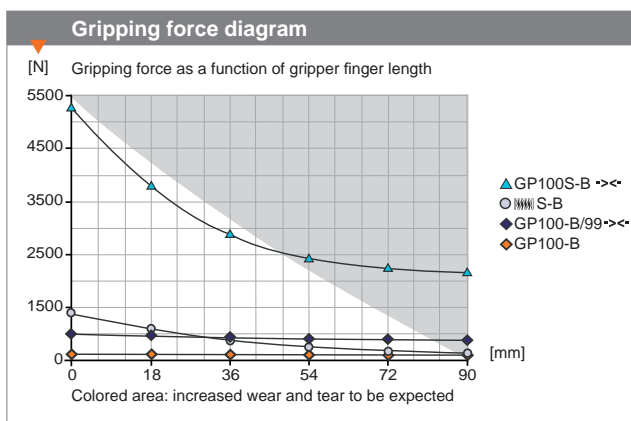

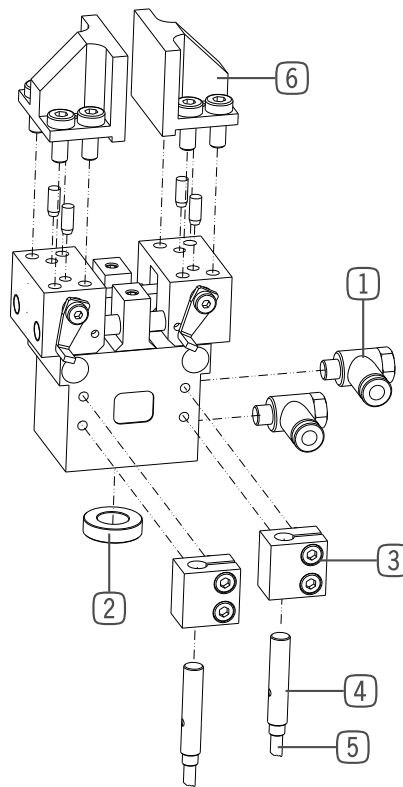
## Recommended accessories:

### ① Pneumatic fittings

Version: Angled

To match	Order no.:
GP12	WVM3
GP19	WVM5
GP30	WVM5
GP45	WVM5
GP75	WV1/8X6
GP100	WV1/8X6

Version: Straight

To match	Order no.:
GP12	GVM3
GP19	GVM5
GP30	GVM5
GP45	GVM5
GP75	GV1/8X6
GP100	GV1/8X6

### ② Centring disc

To match	Order no.:
GP12	ZE10H7X6
GP19	ZE12H7X4
GP30	ZE15H7X4
GP45	ZE20H7X4
GP75	ZE20H7X4
GP100	ZE30H7X4

### ③ Mounting block

To match	Order no.:
GP12	KB3M
GP19	KB3
GP30	KB5
GP45	KB6.5

### ④ Inductive proximity switch

Version: Cable 5 m

To match	Order no.:
GP12	NJ3-E2-03
GP19	NJ3-E2-03
GP30	NJ5-E2
GP45	NJ6.5-E2-01
GP75	NJ8-E2
GP100	NJ8-E2

Version: Cable 0.3 m / Connector M8

To match	Order no.:
GP12	NJ3-E2SK
GP19	NJ3-E2SK
GP30	NJ5-E2SK

Version: Connector M8

To match	Order no.:
GP45	NJ6.5-E2S
GP75	NJ8-E2S
GP100	NJ8-E2S

### ⑤ Plug-in connector

Version: Angled / Cable 5 m / Socket M8 (female)

To match	Order no.:
all	KAW500

Version: Straight / Cable 5 m / Socket M8 (female)

To match	Order no.:
all	KAG500

### ⑥ Universal jaw set

Version: Aluminium\*

To match	Order no.:
GP12	UB12
GP19	UB19
GP30	UB30
GP45	UB45
GP75	UB75
GP100	UB100

\* also available in steel